

PLAN VIEW
LAYOUT 1
SEE NOTE 6

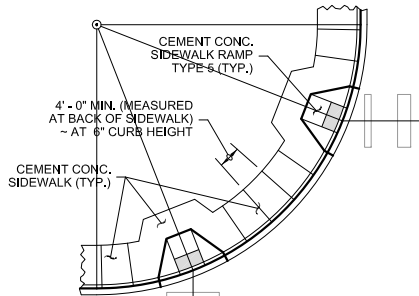

PLAN VIEW
LAYOUT 2
SEE NOTE 6

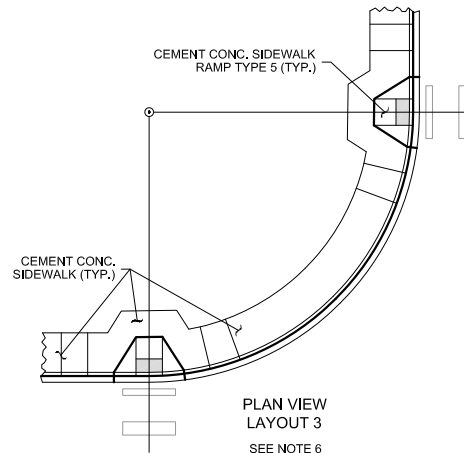

PLAN VIEW
LAYOUT 3
SEE NOTE 6

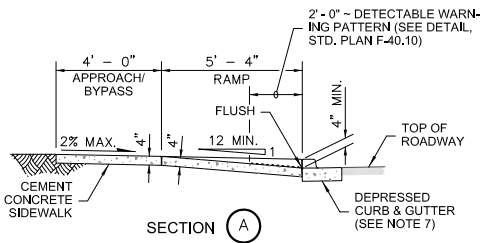

SECTION A

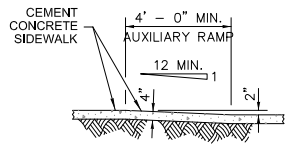

SECTION B

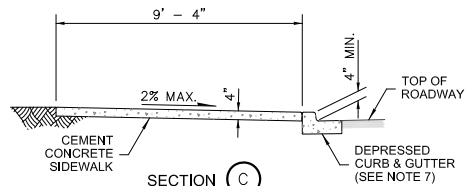

SECTION C

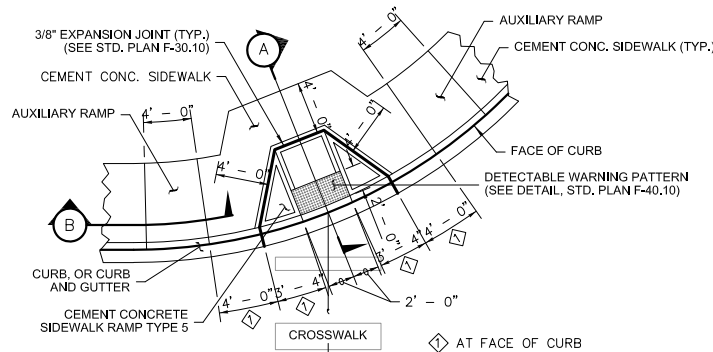

PLAN VIEW
SIDEWALK RAMP TYPE 5
FOR LAYOUTS 1, 2, & 3

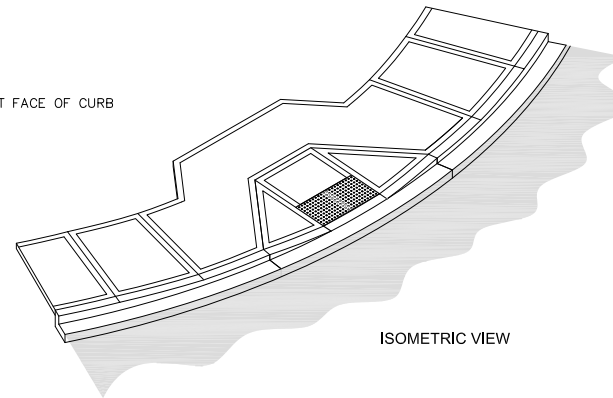

ISOMETRIC VIEW

NOTES

1. The ramp shown on this plan is ideal and assumes optimal roadway geometric design. A given initial curb height of 6" is first reduced to 4" via the Auxiliary Ramp, staging the final descent to the roadway. Adjustments must be made for conditions in the field such as roadway grade, existing curb height, etc. The dimensions shown are the minimums unless labeled otherwise.
2. The maximum allowable ramp slope is 12H:1V (8.34%) grade. The Federal Administration (FHWA) does not accept sidewalk ramps with slopes steeper than 12H:1V. Flatter ramp slopes are permissible. Field verify the forms before pouring concrete.
3. To the maximum extent feasible, ramp cross slopes shall not exceed 2%.
4. The bottom of the ramp shall have a level area (not in excess of 2% in any direction), 4' X 4'.
5. Avoid placing drainage structures, junction boxes or other obstructions in front of ramp access areas.
6. Layouts 1, 2, & 3 require two (2) of this bid item: "Cement Conc. Sidewalk Ramp Type 5". The bid item does not include the adjacent Curb (or Curb & Gutter), or Sidewalk.
7. Curb & Gutter is shown, see the Contract Plans for the curb design specified. See Standard Plan F-10.12 for curb details.
8. See Standard Plan F-30.10 for Cement Concrete Sidewalk details, sections, etc.

5-12

STD. PLAN NO.

APPROVED BY	REVISED DATE	CITY OF CENTRALIA
CITY ENGINEER	06/2017	
		SIDEWALK RAMP TYPE 5 WITH LAYOUTS